

MAYA

DATASHEET | SPECIFICATIONS

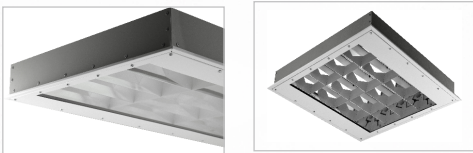

PHOTOS



CHARACTERISTIC

LED luminaire with polycarbonate diffuser with high lumen into the ceiling M600.

USE

Industrial areas

Sport facilities



TECHNICAL SPECIFICATIONS

ELECTRICAL PARAMETERS

Light source	» LED
AC voltage	» AC 230 V / 50 Hz
Connection	» terminal block
Driver	» electronic driver
Dimming	» non-dimmable (not labeled) » DALI (DALI) » corridor function (EPS-C)
Emergency module	» No

LIGHT PARAMETERS

Optical system	» narrow beam (C)
Light distribution	» direct
Color rendering index	» Ra > 80
Color temperature	» 4 000 K
Service life	» > 100 000 (L80B50)

CONSTRUCTION

Housing	» powder-coated steel sheet
Color	» RAL 9003
Surface	» mat
Cover	» polycarbonate diffuser

SAFETY

Protection class	» I
Ambient operating temperature	» -5 / +40 °C
Electrical part protection	» IP 20
Optical part protection	» IP 54
Mounting on normally flammable materials	» YES

MOUNTING

Type	» do pohledu M600, 600x600 (6), 1200x600 (12)
Recommended height	» from 4 m to 10 m

ACCESSORIES

Clips	» NO
Mounting accessories	» hook suspension » bracket for surface mounting (on request)

This luminaire contains built-in LED lamps.

The lamps cannot be changed in the luminaire.

ELEKTRO-LUMEN | MAYA 874/2012

LIGHT DISTRIBUTION CURVE

MAYA 6 CPC 13k0 840

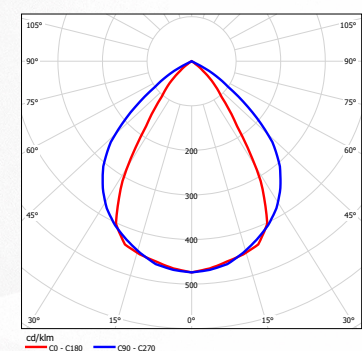

VARIANTS

DATASHEET MAYA

TYPE	POWER	LUMINOUS FLUX	COLOR TEMPERATURE	SERVICE LIFE	WEIGHT
Name	Watt (W)	Lumen (lm)	Kelvin (K)	L80B50 (hod.)	Kilogram (kg)
MAYA 6 ... 13k0 840	86	12 900	4 000	> 100 000	14
MAYA 6 ... 17k8 840	120	17 800	4 000	> 100 000	14
MAYA 12 ... 26k0 840	172	25 800	4 000	> 100 000	23
MAYA 12 ... 35k6 840	240	35 600	4 000	> 100 000	23

LEGENDA

MAYA 6 CPC 17k8 840 DALI

	name
	rastr 600x600 (6)
	narrow beam(C), polycarbonate (PC)
	luminous flux 17 800 lm
	color rendering index Ra > 80, color temperature 4 000 K
	dimming DALI (DALI)

DIMENSIONS

MAYA 6

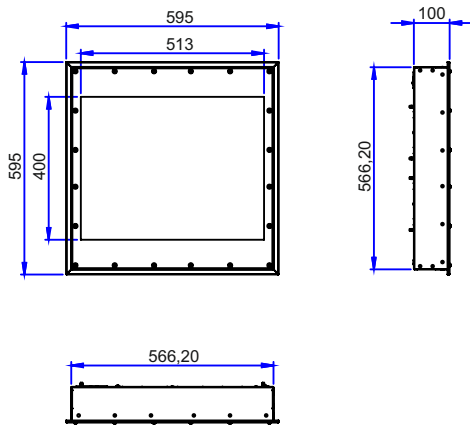

MAYA 12

