

NITYA G3

DATASHEET | SPECIFICATIONS



FOTOGALERIE



NITYA S G3

NITYA M G3

NITYA L G3

NITYA XL G3

TECHNICAL SPECIFICATIONS

ELECTRICAL PARAMETERS

Light source	» LED
AC voltage	» AC 220–240 V / 50–60 Hz
Connection	» protection class II – leading out cable 30 cm
Driver	» electronic driver with surge protection L/N-Ground 10 kV
Surge protection	» additional surge protection 20 kA (1,5 kV)
Dimming	» non-dimmable (not labeled) » DALI (DALI)
	» preparation for wireless communication NEMA (N) » Zhaga (Z)
	- only for NITYA L and NITYA XL
Emergency module	» NO

LIGHT PARAMETERS

Optical system	» (P51), (P52), (T5A), (L19), (C51), (C52), (C56)
Light distribution	» direct
Color rendering index	» Ra > 70
Color temperature	» AMBER (BLUE FREE) » 2 200 K » 2 700 K » 3 000 K » 4 000 K
Service life	» > 100 000 hours (L90B10)

CONSTRUCTION

Housing	» aluminum cast
Color	» RAL 9022
Surface	» mat
Cover	» safety glass

SAFETY

Protection class	» II
Ambient operating temperature	» max. -40 / +50 °C
Ingress protection	» IP 66
Impact protection	» IK 09
Mounting on normally flammable materials	» YES

MOUNTING

Type	» mounting on a caliper (part of the luminaire), tilt 0–90°
Recommended height	» from 6 to 15 m

ACCESSORIES

Clips	» NO
-------	------

CHARACTERISTIC

High-performance flood light designed for a wide range of applications.

USE

- Sports facilities
- Open areas
- Parkings
- Public areas

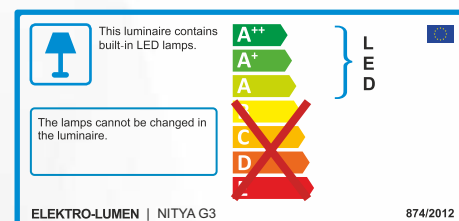

LIGHT DISTRIBUTION CURVE

NITYA G3 T5A

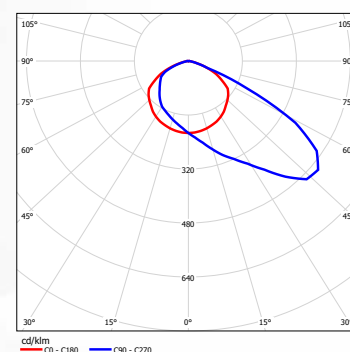

VARIANTS

DATASHEET NITYA G3

VARIANTS (chip 5050)	POWER (W)					LUMINAIRE OUTPUT FLUX (lm)		LUMINAIRE EFFICIENCY (lm/W)	SERVICE LIFE (hrs.)	WEIGHT
	Color temperature (K)					min	max	Up to	L90B10	kg*
Catalog name	BLUE FREE AMBER U500 < 1.7%	2200K Ra 70 U500 < 7%	2700K Ra 70 U500 < 10.6%	3000K Ra 70 U500 < 14%	4000K Ra 70 U500 < 21%					
NITYA S G3 II Lxx 8k9	60,7	60,1	54,8	-	-	6 517	7 804	142,4	> 100 000	4.4
NITYA S G3 II Lxx 10k7	-	-	-	60,9	57,3	7 835	9 383	163,8	> 100 000	4.4
NITYA S G3 II Lxx 12k7	91,5**	89,8**	81,6**	-	-	9 299	11 137	136,5	> 100 000	4.4
NITYA S G3 II Lxx 15k3	-	-	-	89,8**	84,9**	11 203	13 417	158,0	> 100 000	4.4
NITYA M G3 II Lxx 16k4	113	112	102	-	-	12 333	14 481	142,0	> 100 000	8.0
NITYA M G3 II Lxx 19k0	-	-	-	112	106	14 288	16 777	158,3	> 100 000	8.0
NITYA M G3 II Lxx 20k6	146**	145**	133**	-	-	15 491	18 190	136,8	> 100 000	8.0
NITYA M G3 II Lxx 24k0	-	-	-	145**	137**	18 048	21 192	154,7	> 100 000	8.0
NITYA L G3 II Lxx 23k1	157	156	142	-	-	17 903	21 120	148,7	> 100 000	12.5
NITYA L G3 II Lxx 27k0	-	-	-	156	147	20 925	24 686	167,9	> 100 000	12.5
NITYA L G3 II Lxx 28k7	201**	200**	182**	-	-	22 243	26 240	144,2	> 100 000	12.5
NITYA L G3 II Lxx 33k5	-	-	-	200**	188**	25 963	30 629	162,9	> 100 000	12.5
NITYA XL G3 II Lxx 33k5	228	227	207	-	-	26 210	30 629	148,0	> 100 000	21.0
NITYA XL G3 II Lxx 39k0	-	-	-	227	214	30 514	35 658	166,6	> 100 000	21.0
NITYA XL G3 II Lxx 48k0	341**	339**	310**	-	-	37 555	43 886	141,6	> 100 000	21.0
NITYA XL G3 II Lxx 55k8	-	-	-	339**	319**	43 658	51 018	159,9	> 100 000	21.0

* The weight may vary slightly depending on the luminaire variant.

** Maximum ambient temperature Ta=40°C.

DIMENSIONS

NITYA S G3

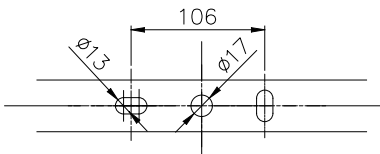
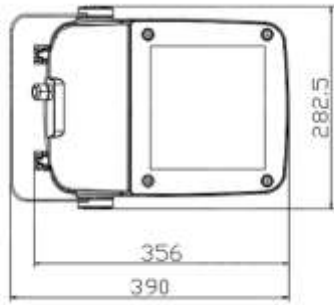

NITYA M G3

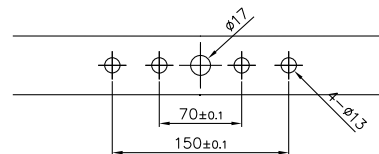
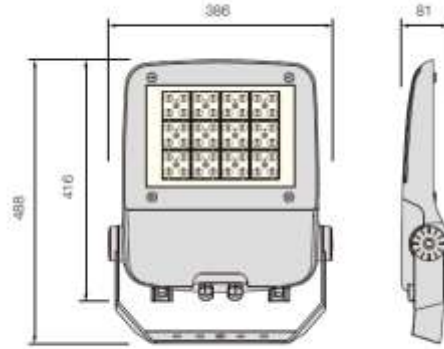

NITYA L G3

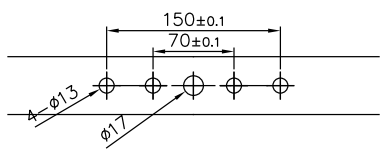
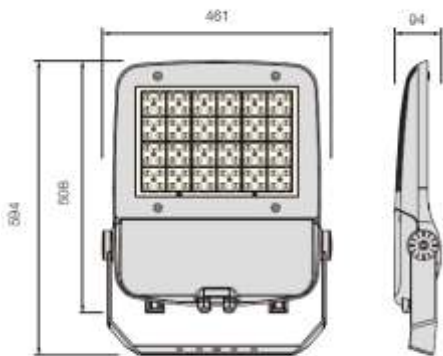

NITYA XL G3

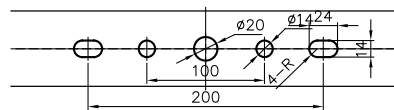
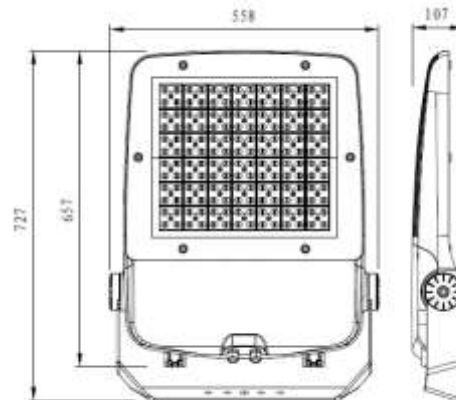

CODE DESCRIPTION

NITYA G3 II M01BL2 8k0 730 B124 4OCA S G H2S ENEC	
Name	
Class	
II	Class II
Luminaire generation	
M01	Roads
L01	Roads
P01	Directional
U01	Area
K01	Combined optics
BL1/BL2	BACK Light shades
Luminous flux marking (source)	
Ra 70 / 3 000 K	
LED module marking	
B	TYP LED module
1	
2	
4	Mask type
Driver type	
42	DALI driver + 2 pole terminal block
44	DALI driver + 4 pole terminal block
40	DALI driver + knife switch
DZT	D4i + Zhaga
N	NEMA connector, 7 pin (DALI driver)
C	Constant luminous flux (CLO)
A	AstroDim
S	Surge protection 10kV
G	Gesis connector
H	H05(07)RN-F cable (1 mm ²)
C	CYKY cable (1,5 mm ²)
2	2 core cable
4	4 core cable
S	Standard – 25 cm length of cable (led out of the luminaire)
1	1 meter (length in whole meters)
ENEC certification	