

WOODLINE

DATASHEET | SPECIFICATIONS

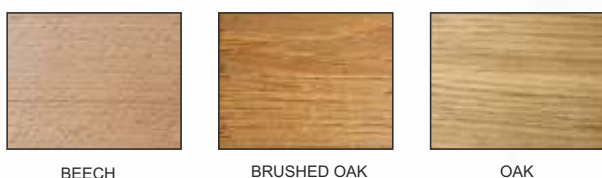

SURFACE FINISH



BEECH

BRUSHED OAK

OAK

TECHNICAL SPECIFICATIONS	
ELECTRICAL PARAMETERS	
Light source	» LED
AC voltage	» AC 230 V / 50 Hz
Connection	» terminal block
Driver	» electronic driver
Dimming	» non-dimmable (not labeled) » DALI (DALI) » corridor function (EPS-C)
Emergency module	» NO
LIGHT PARAMETERS	
Optical system	» diffuser
Light distribution	» direct » direct + indirect (DI)
Color rendering index	» Ra > 80
Color temperature	» 3 000 K » 4 000 K
Service life	» 80 000 hours (L80)
CONSTRUCTION	
Housing	» solid wood - oak
Cover	» opal (DSO) » microprism (DMPP)
SAFETY	
Protection class	» I
Ambient operating temperature	» +5 / +35 °C
Ingress protection	» IP 40
Impact protection	» IP 40
Mounting on normally flammable materials	» NO
MOUNTING	
Type	» suspension
Recommended height	» max up to 5 m
ACCESSORIES	
Buckles	» NO
Mounting accessories	» rope hanger

CHARACTERISTIC

Wooden design LED
Lamp for interiors and architects
Tonic Projects. Can be done
in the indirect version.

USE

- commercial premises
- Offices
- Corridors
- department stores
- gallery
- restaurant



This luminaire contains built-in LED lamps.

The lamps cannot be changed in the luminaire.

A++
A+
A
C
D

LED

ELEKTRO-LUMEN | WOODLINE 874/2012

LIGHT DISTRIBUTION CURVE

WOODLINE DPO

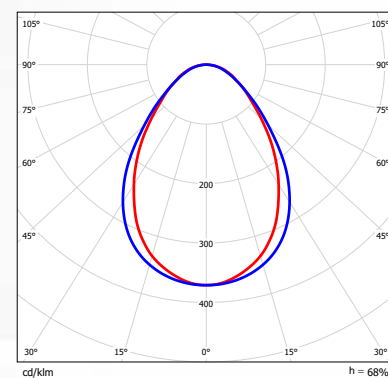

VARIANTS

DATASHEET WOODLINE

TYPE	POWER	LUMINOUS FLUX	COLOR TEMPERATURE	SERVICE LIFE	WEIGHT
Name	(W)	Lumen (lm)	Kelvin (K)	L80 (hod.)	Kg*
WOODLINE 12 ... 1k9 840	12	1 900	4 000	> 80 000	7,0
WOODLINE 12 ... 3k2 840	20	3 200	4 000	> 80 000	7,0
WOODLINE 12 ... 4k6 840	28	4 600	4 000	> 80 000	7,0
WOODLINE 12 ... 6k4 840	41	6 400	4 000	> 80 000	7,0
WOODLINE 12 DI ... 2k4 840	15	2 400	4 000	> 80 000	7,0
WOODLINE 12 DI ... 3k9 840	24	3 900	4 000	> 80 000	7,0
WOODLINE 12 DI ... 5k7 840	35	5 750	4 000	> 80 000	7,0
WOODLINE 12 DI ... 8k0 840	51	8 000	4 000	> 80 000	7,0

Toleranz optical und elektrischer Parameter $\pm 10\%$

*Weight may vary depending on the lamp variant

LEGEND

WOODLINE 12 DI DPO 5k7 840

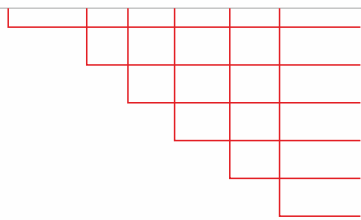

name

length 1218 mm

light distribution (direct + indirect)

diffuser satin opal

luminous flux 5,700 K

color rendering index Ra > 80, chromaticity temperature 4,000 K

DIMENSIONS

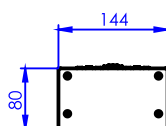
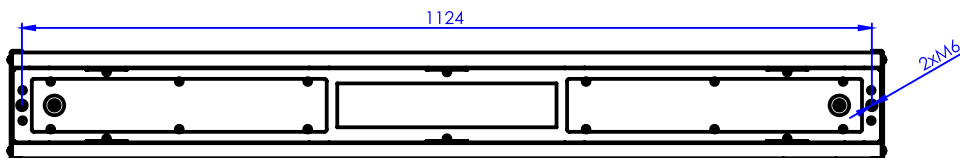
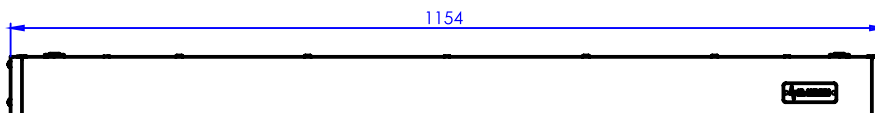

POSSIBILITY OF CUSTOM LABELING

